

BCF611C

English
繁體中文

02
07

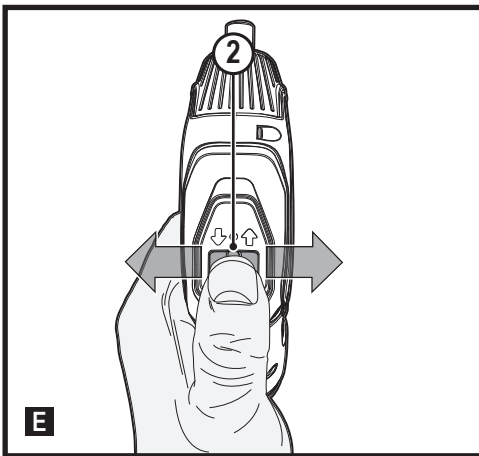
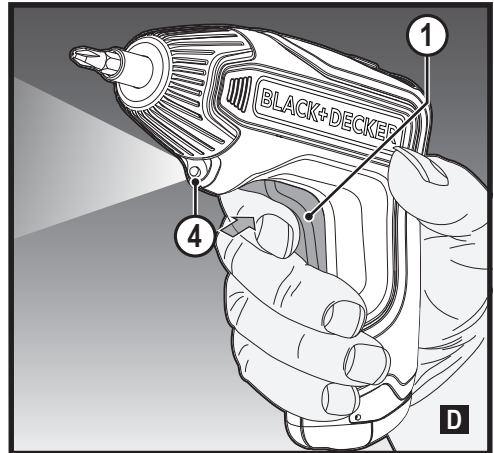
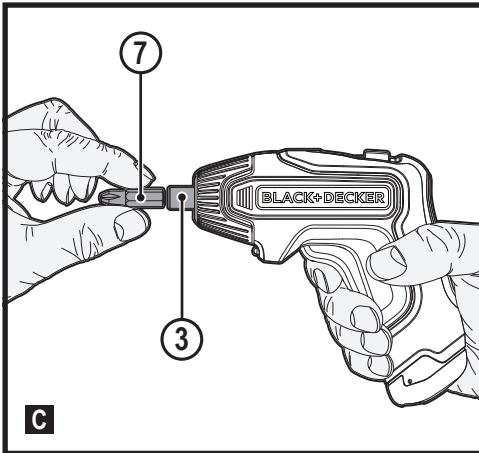
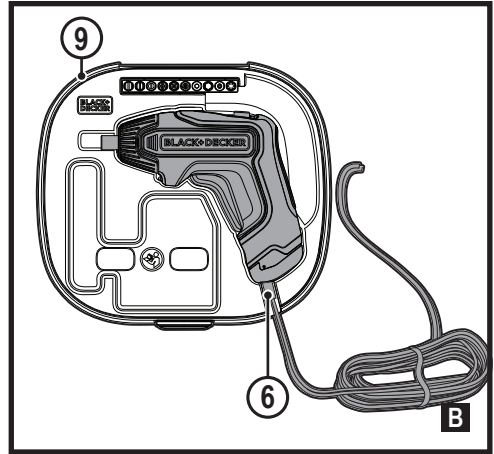
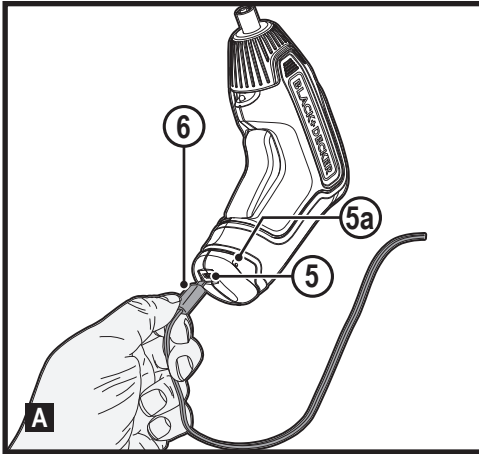

Intended use

Your BLACK+DECKER™ BCF611C screwdriver has been designed for screwdriving applications. This tool is intended for consumer use only.

Safety instructions

General power tool safety warnings

 **Warning! Read all safety warnings, instructions, illustrations and specifications provided with this power tool.** Failure to follow all instructions listed below may result in electric shock, fire and/or serious injury.

Save all warnings and instructions for future reference.

The term "power tool" in the warnings refers to your mains-operated (corded) power tool or battery-operated (cordless) power tool.

1. **Work area safety**
 - a. **Keep work area clean and well lit.** Cluttered or dark areas invite accidents.
 - b. **Do not operate power tools in explosive atmospheres, such as in the presence of flammable liquids, gases or dust.** Power tools create sparks which may ignite the dust or fumes.
 - c. **Keep children and bystanders away while operating a power tool.** Distractions can cause you to lose control.
2. **Electrical safety**
 - a. **Power tool plugs must match the outlet. Never modify the plug in any way. Do not use any adapter plugs with earthed (grounded) power tools.** Unmodified plugs and matching outlets will reduce risk of electric shock.
 - b. **Avoid body contact with earthed or grounded surfaces such as pipes, radiators, ranges and refrigerators.** There is an increased risk of electric shock if your body is earthed or grounded.
 - c. **Do not expose power tools to rain or wet conditions.** Water entering a power tool will increase the risk of electric shock.
 - d. **Do not abuse the cord. Never use the cord for carrying, pulling or unplugging the power tool. Keep cord away from heat, oil, sharp edges or moving parts.** Damaged or entangled cords increase the risk of electric shock.
 - e. **When operating a power tool outdoors, use an extension cord suitable for outdoor use.** Use of a cord suitable for outdoor use reduces the risk of electric shock.
 - f. **If operating a power tool in a damp location is unavoidable, use a residual current device (RCD) protected supply.** Use of an RCD reduces the risk of electric shock.
3. **Personal safety**
 - a. **Stay alert, watch what you are doing and use common sense when operating a power tool.** Do not use a power tool while you are tired or under the influence of drugs, alcohol or medication. A moment of inattention while operating power tools may result in serious personal injury.
 - b. **Use personal protective equipment. Always wear eye protection.** Protective equipment such as dust mask, non-skid safety shoes, hard hat, or hearing protection used for appropriate conditions will reduce personal injuries.
 - c. **Prevent unintentional starting. Ensure the switch is in the off-position before connecting to power source and/or battery pack, picking up or carrying the tool.** Carrying power tools with your finger on the switch or energising power tools that have the switch on invites accidents.
 - d. **Remove any adjusting key or wrench before turning the power tool on.** A wrench or a key left attached to a rotating part of the power tool may result in personal injury.
 - e. **Do not overreach. Keep proper footing and balance at all times.** This enables better control of the power tool in unexpected situations.
 - f. **Dress properly. Do not wear loose clothing or jewellery. Keep your hair, clothing and gloves away from moving parts.** Loose clothes, jewellery or long hair can be caught in moving parts.
 - g. **If devices are provided for the connection of dust extraction and collection facilities, ensure these are connected and properly used.** Use of dust collection can reduce dust-related hazards.
 - h. **Do not let familiarity gained from frequent use of tools allow you to become complacent and ignore tool safety principles.** A careless action can cause severe injury within a fraction of a second.
4. **Power tool use and care**
 - a. **Do not force the power tool. Use the correct power tool for your application.** The correct power tool will do the job better and safer at the rate for which it was designed.
 - b. **Do not use the power tool if the switch does not turn it on and off.** Any power tool that cannot be controlled with the switch is dangerous and must be repaired.
 - c. **Disconnect the plug from the power source and/or the battery pack from the power tool before making any adjustments, changing accessories, or storing power tools.** Such preventive safety measures reduce the risk of starting the power tool accidentally.
 - d. **Store idle power tools out of the reach of children and do not allow persons unfamiliar with the power tool or these instructions to operate the power tool.** Power tools are dangerous in the hands of untrained users.
 - e. **Maintain power tools and accessories. Check for misalignment or binding of moving parts, breakage of parts and any other condition that may affect the power tools operation. If damaged, have the power tool repaired before use.** Many accidents are caused by poorly maintained power tools.
 - f. **Keep cutting tools sharp and clean.** Properly maintained cutting tools with sharp cutting edges are less likely to bind and are easier to control.
 - g. **Use the power tool, accessories and tool bits etc. in accordance with these instructions, taking into account the working conditions and the work to be performed.** Use of the power tool for operations different from those intended could result in a hazardous situation.

- h. **Keep handles and grasping surfaces dry, clean and free from oil and grease.** Slippery handles and grasping surfaces do not allow for safe handling and control of the tool in unexpected situations.

5. Battery tool use and care

- a. **Recharge only with the charger specified by the manufacturer.**
A charger that is suitable for one type of battery pack may create a risk of fire when used with another battery pack.
- b. **Use power tools only with specifically designated battery packs.** Use of any other battery packs may create a risk of injury and fire.
- c. **When battery pack is not in use, keep it away from other metal objects, like paper clips, coins, keys, nails, screws, or other small metal objects, that can make a connection from one terminal to another.**
Shorting the battery terminals together may cause burns or a fire.
- d. **Under abusive conditions, liquid may be ejected from the battery; avoid contact. If contact accidentally occurs, flush with water. If liquid contacts eyes, additionally seek medical help.** Liquid ejected from the battery may cause irritation or burns.
- e. **Do not use a battery pack or tool that is damaged or modified.** Damaged or modified batteries may exhibit unpredictable behaviour resulting in fire, explosion or risk of injury.
- f. **Do not expose a battery pack or tool to fire or excessive temperature.** Exposure to fire or temperature above 130 °C may cause explosion.
- g. **Follow all charging instructions and do not charge the battery pack or tool outside the temperature range specified in the instructions.** Charging improperly or at temperatures outside the specified range may damage the battery and increase the risk of fire.
6. **Service**
- a. **Have your power tool serviced by a qualified repair person using only identical replacement parts.**
This will ensure that the safety of the power tool is maintained.
- b. **Never service damaged battery packs.** Service of battery packs should only be performed by the manufacturer or authorized service providers.

- ◆ **Hold the power tool by insulated gripping surfaces, when performing an operation where the fasteners may contact hidden wiring.** Fasteners contacting a "live" wire may make exposed metal parts of the power tool "live" and could give the operator an electric shock.
- ◆ **Wear ear protectors with impact wrenches.** Exposure to noise can cause hearing loss.
- ◆ **Use auxiliary handles supplied with the tool.** Loss of control can cause personal injury.
- ◆ **Use clamps or another practical way to secure and support the work piece to a stable platform.** Holding the work by hand or against your body leaves it unstable and may lead to loss of control.
- ◆ **Before driving fasteners into walls, floors or ceilings, check for the location of wiring and pipes.**
- ◆ **The intended use is described in this instruction manual.**
- ◆ **The use of any accessory or attachment or performance of any operation with this tool other than those recommended in this instruction manual may present a risk of personal injury and/or damage to property.**

Safety of others

- ◆ This tool is not intended for use by persons (including children) with reduced physical, sensory or mental capabilities, or lack of experience and knowledge, unless they have been given supervision or instruction concerning use of the appliance by a person responsible for their safety.
- ◆ Children should be supervised to ensure that they do not play with the appliance.

Residual risks

Additional residual risks may arise when using the tool which may not be included in the enclosed safety warnings. These risks can arise from misuse, prolonged use etc.

Even with the application of the relevant safety regulations and the implementation of safety devices, certain residual risks can not be avoided. These include:

- ◆ Injuries caused by touching any rotating/moving parts.
- ◆ Injuries caused when changing any parts, blades or accessories.
- ◆ Injuries caused by prolonged use of a tool. When using any tool for prolonged periods ensure you take regular breaks.
- ◆ Impairment of hearing.
- ◆ Health hazards caused by breathing dust developed when using your tool (example:- working with wood, especially oak, beech and MDF.)

Additional power tool safety warnings



Warning! Additional safety warnings for screw-drivers.

Labels on tool

The following pictograms along with the date code are shown on the tool:



Warning! To reduce the risk of injury, the user must read the instruction manual.



Do not stare at operating lamp.

Additional safety instructions for batteries

Batteries

- ◆ Never attempt to open for any reason.
- ◆ Do not expose the battery to water.
- ◆ Do not store in locations where the temperature may exceed 40 °C.
- ◆ When disposing of batteries, follow the instructions given in the section "Protecting the environment".



Read the instruction manual before use.



Do not attempt to charge damaged batteries.

Features

This tool includes some or all of the following features:

1. On/off switch
2. Forward/reverse slider
3. Bit holder
4. LED work light
5. Charging port
6. USB connector or Charger
7. Bit
8. Case
9. Case insert

Charging the battery (fig. A, B)

- ◆ Insert the USB connector (6) into the charging port (5).
- ◆ The charging indicator (5a) will illuminate during charging.
- ◆ The tool can also be charged while it is in the case (9), as illustrated in figure B.

Fitting and removing a screwdriver bit (fig. C)

This tool uses screwdriver bits and drill bits with a 6.35 mm hexagonal shank.

- ◆ To fit a bit, insert the bit shaft (7) into the bit holder (3).
- ◆ To remove a bit, pull the bit shaft (7) out of the bit holder (3).

LED work light (fig. D)

The LED work light (4) is activated automatically when the on/off switch (1) is depressed. The LED will also illuminate when the trigger is depressed and the forward/reverse slider (2) is in

the locked off position (central position).

Selecting the direction of rotation (fig. E)

For drilling and for tightening screws, use forward rotation. For loosening screws or removing a jammed drill bit, use reverse rotation.

- ◆ To select forward rotation, push the forward/reverse slider (2) to the forward position.
- ◆ To select reverse rotation, push the forward/reverse slider (2) to the rearward position.
- ◆ To lock the tool, set the forward/reverse slider into the centre position.

Screwdriving

- ◆ Select forward or reverse rotation using the forward/reverse slider (2).
- ◆ To switch the tool on, press the on/off switch (1).
- ◆ To switch the tool off, release the on/off switch (1).

Hints for optimum use

Screwdriving

- ◆ Always use the correct type and size of screwdriver bit.
- ◆ If screws are difficult to tighten, try applying a small amount of washing liquid or soap as a lubricant.
- ◆ Always hold the tool and screwdriver bit in a straight line with the screw.

Maintenance

Your BLACK+DECKER tool has been designed to operate over a long period of time with a minimum of maintenance. Continuous satisfactory operation depends upon proper tool care and regular cleaning.

Your charger does not require any maintenance apart from regular cleaning.

Warning! Before performing any cleaning or maintenance on the tool, unplug the charger.

- ◆ Regularly clean the ventilation slots in your tool using a soft brush or dry cloth.
- ◆ Regularly clean the motor housing using a damp cloth. Do not use any abrasive or solvent-based cleaner.

Protecting the environment



Separate collection. Products and batteries marked with this symbol must not be disposed of with normal household waste.

Products and batteries contain materials that can be recovered or recycled reducing the demand for raw materials. Please recycle electrical products and batteries according to local provisions. Further information is available at www.2helpU.com

Technical data

		BCF611C
Voltage	V _{DC}	3.6V(4V Max)
No-load speed	min ⁻¹	180
Hard stall torque	Nm	5.5
Max. torque	Nm	5.5
Bit holder	mm	6.35
Weight	kg	1.6

Battery		
Battery type		Li-Ion
Ah rating		1.5

Service Information

BLACK+DECKER offers a full network of company-owned and authorized service locations throughout Asia. All BLACK+DECKER Service Centers are staffed with trained personnel to provide customers with efficient and reliable product service.

Whether you need technical advice, repair, or genuine factory replacement parts, contact the BLACK+DECKER location nearest to you.

Note

- ◆ BLACK+DECKER's policy is one of continuous improvement to our products and, as such, we reserve the right to change product specifications without prior notice.
- ◆ Standard equipment and accessories may vary by country.
- ◆ Product specifications may differ by country.

請注意！各地區上市產品/配件不盡相同，請依台灣繁體中文說明書的內容為主。

設計用途

您的BLACK+DECKER™ BCF611C 鋰電起子機設計用於一般螺絲的組裝。本工具僅供一般消費者 DIY 家庭使用，營業使用者不適用百得一年保修條款。

安全說明

電動工具通用安全警告



警告！請閱讀安全警告及所有指示。不遵循下列的這些警告和指示可能會導致觸電、火災及/或嚴重傷害。

以下列示所有警告中的術語「電動工具」是指電源驅動(插電)電動工具或電池驅動(充電)電動工具。

1. 工作場地安全

- 請保持工作場地清潔明亮。混亂或昏暗的場地會引發事故。
- 請勿在易爆環境，如有易燃液體、氣體或粉塵的環境中操作電動工具。電動工具產生的火花會點燃粉塵或氣體。
- 請等待兒童和旁觀者離開之後才操縱電動工具。分心會導致您疏忽於控制。

2. 電氣安全

- 電動工具插頭必須與插座相符，切勿以任何方式改裝插頭。需接地的電動工具不能使用任何配接器插頭。未經改裝的插頭和相符的插座可以減少觸電危險。
- 避免人體接觸接地表面，如管道、散熱片、爐灶和冰箱。若您的身體接地，會增加觸電危險。
- 不得將電動工具暴露在雨中或潮濕環境中。水進入電動工具會增加觸電危險。
- 請勿濫用電線。請勿使用電線來搬運、拉動電動工具或拔出插頭。請讓電線遠離熱、油、銳邊和轉動部件。受損或纏繞的電線會增加觸電危險。
- 若要在戶外使用電動工具，請使用適合戶外使用的延長電線。使用適合戶外使用的電線可減少觸電危險。
- 若必須在潮濕場合使用電動工具，請使用漏電保護器(RCD)。使用 RCD 可降低觸電危險。

3. 人身安全

- 保持警覺；在操作電動工具時，請留意所執行的操作並按照一般的程式執行。請勿在疲倦或在受到毒品、酒精或藥品的影響時使用電動工具。操作電動工具期間注意力分散會導致嚴重人身傷害。
- 請使用個人防護裝置。始終佩戴護目裝置。防護裝置，例如在適當條件下使用的防護面盾、防滑安全鞋、安全帽或聽力保護等裝置可減少人身傷害。
- 避免意外啟動。連接電源及/或電池組、舉抬或搬運電動工具之前，請確定開關處於關閉位置。若搬運電動工具時將手指

放在開關上，或者在電動工具開關開啟時將插頭插入電源插座，這兩種行為都會引發事故。

- 啟動電動工具之前，請卸下所有的調整鑰匙或扳手。遺留在電動工具旋轉部件上的扳手或鑰匙會導致人身傷害。
- 請勿過度伸展雙手。時刻注意腳下與身體的平衡。如此即可在發生意外的情況下更好地控制電動工具。
- 適當穿著。請勿穿寬鬆衣服或佩戴飾品。讓頭髮、衣服和手套遠離活動部件。寬鬆衣服、佩飾和長髮可能會捲入轉動部件。
- 若配備用於連接排屑裝置和集塵設備的裝置，請確定正確連接和使用這些裝置。使用集塵設備可減少與粉塵有關的危險。
- 請勿因為頻繁使用工具而產生的熟悉感而掉以輕心，忽視工具的安全準則。某個粗心的動作可能會在瞬間導致嚴重傷害。

4. 電動工具的使用和注意事項

- 請勿超負荷使用電動工具。請根據不同應用需求選用合適的電動工具。若使用的電動工具正確無誤，該工具能以設計額定值更有效、更安全地執行工作。
- 若開關不能開啟或關閉電源，請勿使用該電動工具。若開關無法控制電動工具，則電動工具存在危險，必須予以維修。
- 在執行任何調整、更換配件或儲存工具之前，必須從電源上拔掉插頭及/或卸下電池組。這類防護性措施可降低電動工具意外啟動的風險。
- 請將閒置的電動工具存放在兒童無法觸及的地方，同時請勿讓不熟悉電動工具或對這些使用說明不瞭解的人員操作電動工具。電動工具在未經培訓的使用者手中會發生危險。
- 維護電動工具和附件。檢查活動部件是否對準或卡住、破損情況以及是否存在影響電動工具運行的其他情況。若有損壞，這必須在使用之前修理電動工具。許多事故都是由於電動工具欠缺維護所導致。
- 保持刀具鋒利和清潔。妥善維護的帶利刃的切割工具不會被輕易卡住，而且更易控制。
- 使用電動工具、配件和工具刀頭等時，請遵循這些指示使用，並且亦需考慮工作環境和有待執行的工作。不按照設計目的使用電動工具會導致危險。
- 保持手柄和握持面乾燥、清潔、不油膩。在意外情況下，濕滑的手柄不能保證握持的安全以及對工具的控制。

5. 電動工具的使用和注意事項

- 只能使用製造商指定的充電器為電池充電。使用僅適合一種電池組的充電器為其他類型的電池組充電會導致火災風險。
- 請使用原廠的電動工具電池組。使用其他非原廠的電池組會導致人身傷害和火災危險。
- 不使用電池組時，請將其遠離如迴紋針、硬幣、鑰匙、釘子、螺釘以及其他可連通電池兩極的金屬物品。電池兩極短路會導致灼傷或火災。
- 濫用電池的情況下，液體會從電池中噴出；避免與液體接觸。如果不慎接觸到電池液，請用水沖洗。如果電池液接觸到雙眼，請就醫。從電池噴出的液體會刺激皮膚或造成灼傷。

- e) 請勿使用已經損壞或改動的電池組或工具。損壞或改動的電池可能表現出不可預計的行為，導致火災、爆炸或傷害風險。
- f) 請勿讓電池組或工具暴露於火中或過高溫度的環境中。暴露於火中或溫度超過130°C的環境中可能導致爆炸。
- g) 請遵循所有充電說明，請勿在說明中規定的溫度範圍以外的環境對電池組或工具充電。不當充電或在指定範圍以外的溫度下充電，可能導致電池損壞並增加火災風險。

6. 檢修

- a) 電動工具之修理，僅可由認證的技術人員執行。請勿交由非百得認證服務中心的技術人員進行修理、維護、調整。若產品經由非百得認證的維修工程師拆解、組裝、調整，恕無法適用百得一年家用保修條款。為充份發揮其功能，修理、維護、調整請務必使用原廠零件。百得認證服務中心擁有保修條款解釋權。
- b) 切勿維修損毀的電池組。電池組的維修應僅由製造商或授權服務提供商進行。

電動工具之附加安全警告



警告！ 起子機之附加安全警告。

當在鑽削附件可能觸及暗線或其自身導線的場合進行操作時，要通過絕緣握持面握持工具。鑽削附件碰到帶電導線會使工具外露的金屬零件帶電而使操作者受到電擊。

- ◆ 使用隨工具一同提供的輔助手柄。失控會導致人身傷害。
- ◆ 請使用夾具或採取其它可行的方法，把工件可靠地固定在穩定的平臺上。手持或用身體頂住工件都是不穩定的，會導致操作失控。
- ◆ 在牆上、地板或天花板上鑽孔之前，請檢查電線和管道位置。
- ◆ 本使用手冊描述了工具的設計用途。使用非本使用手冊所建議的任何其他附件或配件，或者使用本工具執行非手冊建議的任何其他操作，都可能存在人身傷害和/或財產損失的危險。

他人的安全

- ◆ 生理、感覺或心理機能不健全的人員（包括兒童）或缺乏經驗及知識的人員，除非由負責其安全的人員提供有關使用此器具的監督或指示，否則不得使用本工具。
- ◆ 必須對兒童進行監督，以確保其不會玩弄本工具。

其他風險

使用本工具時，可能會出現隨附安全警告中所不包括的其他剩餘風險。誤用、長時間使用工具等因素會導致這些風險。即使遵循相關安全規定並採用安全裝置，仍然無法避免某些剩餘風險。此類風險包括：

- ◆ 接觸旋轉/活動部件引起的傷害。
- ◆ 因變更任何零件、刀片或配件而引起的傷害。
- ◆ 因長時間使用工具而引起的傷害。若長時間使用工具，請確保定時休息。
- ◆ 聽力受損。
- ◆ 吸入使用工具時產生的粉塵引起的健康危害（譬如：在木材上使用時，尤其是樺木、山毛櫸和中密度纖維板（MDF））。

工具上的標誌

本工具上具有以下圖示與日期代碼：



警告！為了降低受傷的風險，使用者必須仔細閱讀使用手冊。



切勿直視LED工作燈。

製造年份及號碼(範例)

2020 23 BM
西元年份 週數 號碼

電池和充電器之附加安全指示

- ◆ 電池無論何種原因，均不得嘗試打開電池。
- ◆ 請勿將電池暴露在水中。
- ◆ 請勿將電池存放在溫度可能超過 40 °C 的地方。
- ◆ 在處理電池時，請遵循“保護環境”中的指示。



請在使用前請閱讀使用手冊。



請勿嘗試對損壞的電池充電。

功能部件

本工具包括以下部分或全部功能部件。

1. 開關
2. 正/反轉滑塊
3. 快速夾頭
4. LED工作燈
5. 充電端口
6. USB充電線
7. 起子頭(10件)
8. 工具盒
9. 主機收納位置

為電池充電(圖A, B)

- ◆ 請將USB接頭(6)插入充電端口(5)。
- ◆ 在充電時，充電狀態指示燈(5a)會亮起。
- ◆ 當工具位於工具盒(9)內時，亦可為其充電，如圖B所示。

當工具位於工具盒(9)內時，亦可為其充電，如圖C所示。

該工具使用帶有6.35公釐六角長柄的螺絲刀頭和鑽頭。

- ◆ 如需安裝起子頭，請將該配件(7)插入夾頭(3)中。
- ◆ 如需拆除起子頭，請將該配件(7)從夾頭(3)中拔出。

LED工作燈(圖D)

當按壓開關(1)，LED工作燈(4)就會自動亮起。當按壓扳機開關，且正/反轉滑塊(2)處於鎖定位置(中間位置)，LED工作燈亦會亮起。

選擇轉向(圖E)

如需鑽孔和緊固螺絲，請選擇正向轉動。如需鬆開螺絲，請選擇反向轉動。

- ◆ 要選擇正向轉動，將正向/反向滑塊(2)推到右側。
- ◆ 要選擇反向轉動，將正向/反向滑塊(2)推到左側。
- ◆ 如需鎖定工具，請將正/反轉滑塊推動至中間位置。

緊固

- ◆ 請通過正/反轉滑塊(2)選擇正向轉動或反向轉動。
- ◆ 如需開啟工具，請按壓開關(1)。
- ◆ 如需關閉工具，請鬆開開關(1)。

最佳使用提示

螺絲安裝

- ◆ 請務必選用正確類型和尺寸的螺絲。
- ◆ 若難以緊固螺絲，請用少量清潔劑或肥皂作為潤滑劑。
- ◆ 工具必須始終與螺絲成一直線。

維護

您的BLACK+DECKER工具採用卓越的設計。若要持續取得滿意的操作效果，需要進行正確的工具維護與定期的清潔。除了定期清潔，您的充電器無需任何維護。

警告!對工具執行任何維護之前，請卸下工具內的電池。清潔之前請拔下充電器的插頭。

- ◆ 定期使用濕布清潔電機外殼。請勿使用任何研磨性或溶劑型清潔劑。

保護環境



分類回收。帶有此標誌的產品和電池必須與一般家庭廢物分開處置。

產品和電池包含可重複使用或回收的材料，可降低對原材料的需求。

請根據當地法規回收電氣產品和電池。更多資訊，請造訪 www.2helpU.com

技術資料

		BCF611C
電壓	V _{DC}	3.6V(4V Max)
空載轉速	min ⁻¹	180
最大扭矩	Nm	5.5
夾頭尺寸	mm	6.35
重量	kg	1.6

電壓		
電池類型		鋰電池
額定電流		1.5

4V Max為最大初始電壓(無負載電壓)，標稱電壓為3.6V。

注意

- ◆ BLACK+DECKER的政策是不斷改進產品，因此，我們保留改變產品規格的權利，恕不事先通知。
- ◆ 不同國家，標準設備和配件也會有所不同。
- ◆ 不同國家，產品規格也會有所不同。

經銷商: 特力股份有限公司

地址: 台北市內湖區新湖三路23號1.2.5樓

電話: 0800-008-007

進口/委製廠商: 新加坡商百得電動工具(股)公司台灣分公司

地址: 台北市士林區德行西路33號2樓

電話: 02-2834-1741

