

BLACK+ DECKER

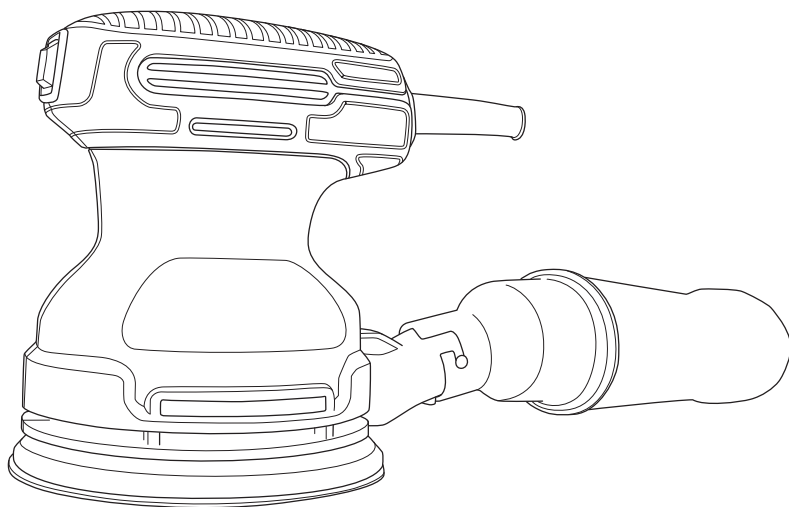

BDERO100

ENGLISH (original instructions) 3
中文(繁體) 7

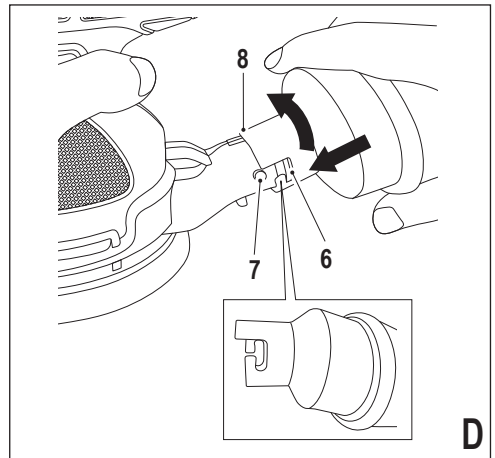
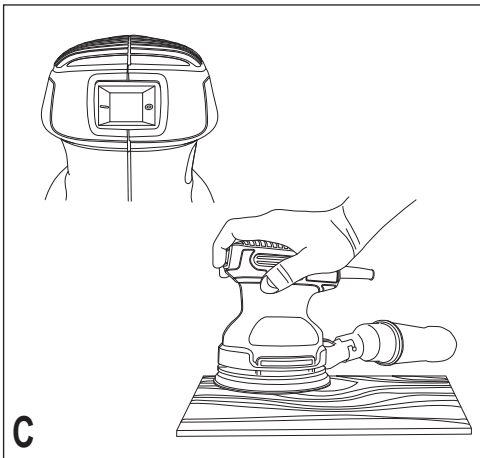
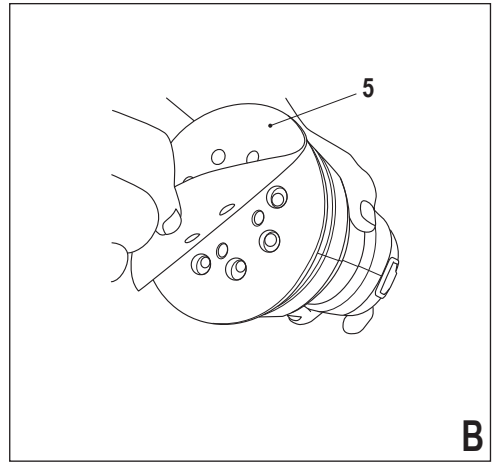
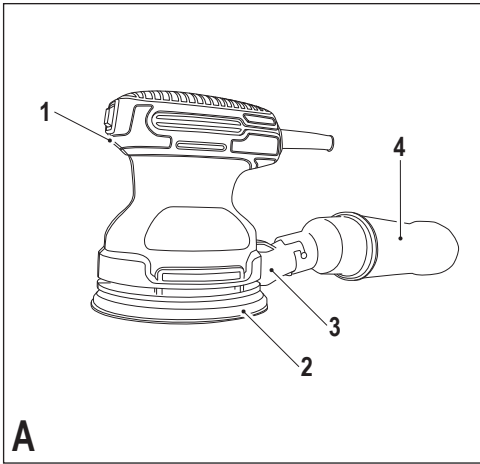

RANDOM ORBIT SANDER BDERO100

Technical data

BDERO100	
Input Voltage	110V 60Hz
Power Input	200W
OPM	12000 OPM
Oscillations	2.4mm
Product size	146*122*170 (w/o dust bag attached) 146*122*282 (w/ dust bag attached)
Product weight	1320g
Cable length	2m

Intended use

Your BLACK+DECKER sander has been designed for sanding wood, metal, plastics and painted surfaces. This tool is intended for consumer use only.

Safety instructions

General power tool safety warnings



WARNING: Read all safety warnings and all instructions. Failure to follow the warnings and instructions listed below may result in electric shock, fire and/or serious injury.

Save all warnings and instructions for future reference.

The term "power tool" in all of the warnings listed below refers to your mains operated (corded) power tool or battery operated (cordless) power tool.

1. Work area safety

- Keep work area clean and well lit.** Cluttered or dark areas invite accidents.
- Do not operate power tools in explosive atmospheres, such as in the presence of flammable liquids, gases or dust.** Power tools create sparks which may ignite the dust or fumes.
- Keep children and bystanders away while operating a power tool.** Distractions can cause you to lose control.

2. Electrical safety

- Power tool plugs must match the outlet. Never modify the plug in any way. Do not use any adapter plugs with earthed (grounded) power tools.** Unmodified plugs and matching outlets will reduce risk of electric shock.
- Avoid body contact with earthed or grounded surfaces such as pipes, radiators, ranges and refrigerators.** There is an increased risk of electric shock if your body is earthed or grounded.
- Do not expose power tools to rain or wet conditions.** Water entering a power tool will increase the risk of electric shock.
- Do not abuse the cord. Never use the cord for carrying, pulling or unplugging the power tool. Keep cord away from heat, oil, sharp edges or moving parts.** Damaged or entangled cords increase the risk of electric shock.
- When operating a power tool outdoors, use an extension cord suitable for outdoor use.** Use of a cord suitable for outdoor use reduces the risk of electric shock.
- If operating a power tool in a damp location is unavoidable, use a residual current device (RCD) protected supply.** Use of an RCD reduces the risk of electric shock.

3. Personal safety

- Stay alert, watch what you are doing and use common sense when operating a power tool. Do not use a power tool while you are tired or under the influence of drugs, alcohol or medication.** A moment of inattention while operating power tools may result in serious personal injury.
- Use personal protective equipment. Always wear eye protection.** Protective equipment such as dust mask, non-skid safety shoes, hard hat, or hearing protection used for appropriate conditions will reduce personal injuries.
- Prevent unintentional starting. Ensure the switch is in the off-position before connecting to power source and/or battery pack, picking up or carrying the tool.** Carrying power tools with your finger on the switch or energising power tools that have the switch on invites accidents.
- Remove any adjusting key or wrench before turning the power tool on.** A wrench or a key left attached to a rotating part of the power tool may result in personal injury.
- Do not overreach. Keep proper footing and balance at all times.** This enables better control of the power tool in unexpected situations.

- f. **Dress properly. Do not wear loose clothing or jewellery. Keep your hair, clothing and gloves away from moving parts.** Loose clothes, jewellery or long hair can be caught in moving parts.
- g. **If devices are provided for the connection of dust extraction and collection facilities, ensure these are connected and properly used.** Use of dust collection can reduce dust-related hazards.
4. **Power tool use and care**
- a. **Do not force the power tool. Use the correct power tool for your application.** The correct power tool will do the job better and safer at the rate for which it was designed.
- b. **Do not use the power tool if the switch does not turn it on and off.** Any power tool that cannot be controlled with the switch is dangerous and must be repaired.
- c. **Disconnect the plug from the power source and/or the battery pack from the power tool before making any adjustments, changing accessories, or storing power tools.** Such preventive safety measures reduce the risk of starting the power tool accidentally.
- d. **Store idle power tools out of the reach of children and do not allow persons unfamiliar with the power tool or these instructions to operate the power tool.** Power tools are dangerous in the hands of untrained users.
- e. **Maintain power tools. Check for misalignment or binding of moving parts, breakage of parts and any other condition that may affect the power tools operation. If damaged, have the power tool repaired before use.** Many accidents are caused by poorly maintained power tools.
- f. **Keep cutting tools sharp and clean.** Properly maintained cutting tools with sharp cutting edges are less likely to bind and are easier to control.
- g. **Use the power tool, accessories and tool bits etc. in accordance with these instructions, taking into account the working conditions and the work to be performed.** Use of the power tool for operations different from those intended could result in a hazardous situation.
5. **Service**
- a. **Have your power tool serviced by a qualified repair person using only identical replacement parts.** This will ensure that the safety of the power tool is maintained.

SAFETY WARNINGS AND INSTRUCTIONS: SANDERS

- **ALWAYS WEAR EYE PROTECTION.**
- Clean your tool out periodically.



WARNING: Some dust created by power sanding, sawing, grinding, drilling, and other construction activities contains chemicals known to cause cancer, birth defects or other reproductive harm. Some examples of these chemicals are:

- lead from lead-based paints,
- crystalline silica from bricks and cement and other masonry products, and
- arsenic and chromium from chemically-treated lumber. (CCA)

Your risk from these exposures varies, depending on how often you do this type of work. To reduce your exposure to these chemicals: work in a well ventilated area, and work with approved safety equipment, such as those dust masks that are specially designed to filter out microscopic particles.

- **Avoid prolonged contact with dust from power sanding, sawing, grinding, drilling, and other construction activities. Wear protective clothing and wash exposed areas with soap and water.** Allowing dust to get into your mouth, eyes, or lay on the skin may promote absorption of harmful chemicals.
- CAUTION:** Wear appropriate hearing protection during use. Under some conditions and duration of use, noise from this product may contribute to hearing loss.



OTHER IMPORTANT SAFETY WARNINGS AND INSTRUCTIONS

EXTENSION CORDS

When using an extension cord, be sure to use one heavy enough to carry the current your product will draw. An undersized cord will cause a drop in line voltage resulting in loss of power and overheating. The following table shows the correct size to use depending on cord length and nameplate ampere rating. If in doubt, use the next heavier gage. The smaller the gage number, the heavier the cord.

SANDING LEAD BASED PAINT

Sanding of lead based paint is NOT RECOMMENDED due to the difficulty of controlling the contaminated dust. The greatest danger of lead poisoning is to children and pregnant women. Since it is difficult to identify whether or not a paint contains lead without a chemical analysis, we recommend the following precautions when sanding any paint:

PERSONAL SAFETY

- No children or pregnant women should enter the work area where the paint sanding is being done until all clean up is completed.
 - A dust mask or respirator should be worn by all persons entering the work area. The filter should be replaced daily or whenever the wearer has difficulty breathing.
- NOTE:** Only those dust masks suitable for working with lead paint dust and fumes should be used. Ordinary painting masks do not offer this protection. See your local hardware dealer for the proper (NIOSH approved) mask.
- NO EATING, DRINKING or SMOKING should be done in the work area to prevent ingesting contaminated paint particles. Workers should wash and clean up BEFORE eating, drinking or smoking. Articles of food, drink, or smoking should not be left in the work area where dust would settle on them.

ENVIRONMENTAL SAFETY

- Paints should be removed in such a manner as to minimize the amount of dust generated.
- Areas where paint removal is occurring should be sealed with plastic sheeting of 4 mils thickness.
- Sanding should be done in a manner to reduce tracking of paint dust outside the work area.

FUNCTIONAL DESCRIPTION

Figure A

- On/off switch
- Sanding pad
- Dust port
- Canister

MOTOR

Your BLACK+DECKER tool is powered by a BLACK+DECKER-built motor. Be sure your power supply agrees with nameplate marking. 110 Volts AC only means your tool will operate on standard 60Hz household power. Do not operate AC tools on DC. A

CLEANING AND DISPOSAL

- All surfaces in the work area should be vacuumed and thoroughly cleaned daily for the duration of the sanding project. Vacuum filter bags should be changed frequently.
- Plastic drop cloths should be gathered up and disposed of along with any dust chips or other removal debris. They should be placed in sealed refuse receptacles and disposed of through regular trash pick-up procedures. During clean up, children and

pregnant women should be kept away from the immediate work area.

- All toys, washable furniture and utensils used by children should be washed thoroughly before being used again.

SAVE THESE INSTRUCTIONS

SYMBOLS

The label on your tool may include the following symbols. The symbols and their definitions are as follows:

V	volts
A	amperes
Hz	hertz
W	watts
min	minutes
~ or AC	alternating current
— or DC	direct current
n ₀	no load speed
ⓘ	Class I Construction (grounded)
⊕	earthing terminal
⚠	safety alert symbol
Ⓜ	Class II Construction (double insulated)
.../min or rpm...	revolutions or reciprocation per minute
SPM	Strokes per minute
📖	Read instruction manual before use
👁	Use proper eye protection
👂	Use proper hearing protection
👃	Use proper respiratory protection

rating of 110 volts AC/DC means that you tool will operate on standard 60Hz AC or DC power. This information is printed on the nameplate. Lower voltage will cause loss of power and can result in over-heating. All BLACK+DECKER tools are factory-tested; if this tool does not operate, check the power supply.

ASSEMBLY/ADJUSTMENT SET-UP



WARNING: Always unplug sander from power supply before any of the following operations.

ATTACHING HOOK AND LOOP SANDING DISCS (FIGURE B)

Your sander is designed to use 125mm sanding discs with the 8 hole dust extraction pattern. For best results, use BLACK+DECKER accessories.

- To attach the sanding disc (5), carefully center it over the sanding pad (2) ensuring the holes in the disc align with the holes in the pad and press the disc firmly in place.
- The hook and loop fastening system sanding disc can be easily removed by simply pulling it off. It can be reused as desired.

OPERATING INSTRUCTIONS



WARNING: To reduce the risk of serious personal injury, read, understand and follow all important safety warnings and instructions prior to using this tool.

SWITCH

o turn the tool ON, hold it as shown in Figure C and push the portion of the switch (1) marked "I". To turn the tool off, push the portion of the switch marked "O"

OPERATION

Grasp the sander and turn it ON. Move it in long, sweeping strokes along the surface, letting it do the work. Pushing down on the tool while sanding actually slows the removal rate and produces an inferior quality finish. Check your work often. This sander is capable of removing material rapidly.

DUST COLLECTION (FIGURE D)



WARNING: Collected sanding dust from sanding surface coatings (polyurethane, linseed oil, etc.) can self-ignite in sander dust bag or elsewhere and cause fire. To reduce risk, empty bag frequently and strictly follow sander manual and coating manufacturer's instructions.

Your sander comes equipped with a cloth canister (4) to collect the dust generated while sanding.

- To attach the canister to the sander, line up the grooves (6) in the canister (4) with the nubs (7) on the dust port (3).
- Slide the canister onto the dust port and turn and turn the canister clockwise to lock it in place as shown in the **insert of Figure D**.
- To remove, turn the canister counterclockwise and slide the canister off.
- To empty the canister, remove it from the dust port and dump the sanding debris into an appropriate trash receptacle.

MAINTENANCE

Use only mild soap and damp cloth to clean the tool. Never let any liquid get inside the tool; never immerse any part of the tool into a liquid.

IMPORTANT: To assure product SAFETY and RELIABILITY, repairs, maintenance and adjustment should be performed by authorized service centers or other qualified service organizations, always using identical replacement parts.

ACCESSORIES



WARNING: The use of any accessory not recommended for use with this tool could be hazardous. Recommended accessories for use with your tool are available from your local dealer or authorized service center.

Service Information

BLACK+DECKER offers a full network of company-owned and authorized service locations throughout Asia. All Black & Decker Service Centers are staffed with trained personnel to provide customers with efficient and reliable power tool service. Whether you need technical advice, repair, or genuine factory replacement parts, contact the Black & Decker location nearest to you.

Notes

- BLACK+DECKER policy is one of continuous improvement to our products and, as such, we reserve the right to change product specifications without prior notice.
- Standard equipment and accessories may vary by country.
- Product specifications may differ by country.
- Complete product range may not be available in all countries.

偏心砂磨機

BDER0100

技術資料

BDER0100	
輸入電壓	110V
輸入功率	200W
空載轉速	12000 OPM
震動幅度	2.4mm
產品尺寸	146*122*170 (未連集塵袋)
	146*122*282 (連集塵袋)
產品重量	1320g
纜線長度	2m

請注意! 各地區上市產品/配件不盡相同, 請依台灣繁體中文說明書的內容為主。

Warning! Attachments and accessories are not the same in each region, please only refer to Taiwan Traditional Chinese description in this manual.

設計用途

BLACK+DECKER 砂磨機設計用於對木材、金屬、塑料和塗漆表面進行砂磨。本工具僅供一般DIY消費者家庭使用, 營業使用者不適用一年保修條款。

安全說明

電動工具一般安全警告



警告! 請閱讀所有安全警告及說明。

不遵循下列這些警告及說明可能會導致觸電、火災及/或嚴重傷害。

請妥善保存所有警告及說明以備將來查閱。

下列所有警告中的名詞「電動工具」是指電源驅動(插電)電動工具, 或者電池驅動(充電)電動工具。

1. 工作場地安全

- 保持工作場地清潔和明亮。混亂或黑暗的場地會引發事故。
- 不要在易爆環境, 如有易燃液體、氣體或粉塵的環境中操作電動工具。電動工具產生的火花會點燃粉塵或氣體。
- 請等待兒童和旁觀者離開之後才操縱電動工具。分心會導致您疏忽於控制。

2. 電氣安全

- 電動工具插頭必須與插座相符。切勿以任何方式改裝插頭。需接地的電動工具不能使用任何配接器插頭。未經改裝的插頭和相符的插座可以減少觸電危險。
- 避免人體接觸接地表面, 如管道、散熱片、爐灶和冰箱。若您的身體接地, 可增加觸電危險。
- 不得將電動工具暴露在雨中或潮濕環境中。水進入電動工具會增加觸電危險。
- 切勿濫用電線。請勿使用電線來搬運、拉動電動工具或拔出插頭。讓電線遠離熱、油、銳邊和活動部件。受損或纏繞的電線會增加觸電危險。
- 若要在戶外使用電動工具, 請使用適合戶外使用的延長電纜。使用適合戶外使用的電線可減少觸電危險。
- 若必須在潮濕場合使用電動工具, 請使用漏電保護器 (RCD)。使用 RCD 可降低觸電危險。

3. 人身安全

- 保持警覺; 在操作電動工具時, 請留意所執行的操作並按照一般的常識執行。切勿在疲倦, 或受到藥物、酒精或治療的影響下操作電動工具。操作電動工具期間注意力分散會導致嚴重人身傷害。
- 使用個人防護裝置。始終佩戴護目裝備。防護裝置, 例如在適當條件下可使用的防塵面具、防滑安全鞋、安全帽或聽力保護等裝置可減少人身傷害。
- 避免意外啟動。連接電源及/或電池組、撿取或搬運電動工具之前, 請確定開關處於關閉位置。搬運電動工具時若將手指放在開關上, 或是在接通開關電源時插入插頭都會引發危險。
- 接通電動工具之前, 請卸下所有的調整鑰匙或扳手。遺留在電動工具旋轉部件上的扳手或鑰匙會導致人身傷害。
- 不要過度伸張雙手。時刻注意腳下和身體的平衡。如此即可在發生意外的情況下更好地控制電動工具。
- 適當穿著。不要穿寬鬆衣服或佩戴飾品。讓您的頭髮、衣服和手套遠離活動部件。寬鬆衣服、佩飾和長髮可能會捲入活動部件。

g. 若配備用於連接排屑裝置、集塵設備的裝置，請確定正確連接和使用這些裝置。使用集塵設備可減少與粉塵有關的危險。

4. 電動工具的使用與注意事項

a. 不要超負荷使用電動工具。根據您的用途使用適當的電動工具。使用適當的電動工具、讓它在設計可負荷的應用內運轉，會讓您更有效、更安全地執行工作。

b. 若開關不能開啟或關閉電源，切勿使用該電動工具。不能用開關來控制的電動工具將存在危險，必須進行維修。

c. 在執行任何調整、更換配件或儲存電動工具之前，請從電源上拔掉插頭及/或卸下電池組。這類防護性措施可降低電動工具意外啟動的風險。

d. 將閒置的電動工具儲存在兒童無法接觸的地方，並且不要讓不熟悉電動工具或對這些說明不瞭解的人員操作電動工具。電動工具在未經培訓的使用者手中會發生危險。

e. 維護電動工具。檢查活動部件是否對準或卡住、是否存在任何破損情況，或任何能影響電動工具運行的其他情況。若有損毀，必須在使用之前修理電動工具。許多事故都是由於電動工具欠缺維護所導致。

f. 保持刀具鋒利和清潔。妥善維護、切削鋒利的切割工具不會輕易卡住並可更輕鬆控制。

g. 遵循這些說明以及工作條件和所要執行的工作使用電動工具、配件和工具刀頭等。不按照設計目使用電動工具將會導致危險。

5. 檢修

a. 本電動工具必須由合格的維修人員並只採用相同的原廠部件來執行檢修。這將確保電動工具的安全性。

安全警告與說明：砂磨機

- 始終佩戴護目裝備。
- 定期清潔工具。



警告：電動砂磨、切鋸、打磨、鑽孔以及其他建造操作所導致的粉塵會導致癌症、生育缺陷或其他生殖傷害。這些化學物質的某些範例包括：

- 來自含鉛油漆的鉛，
- 來自磚石及水泥與其他建工產品的結晶二氧化矽，以及
- 來自化學處理木材的砷和鉻。(CCA)

這些暴露產生的風險根據您做這類工作的頻率而定。為減少您對這些化學物質的接觸：請在通風性好的區域工作，以及使用經認證的安全設備，例如經特別設計用於過濾微粒的防塵面具。

- **避免與電動砂磨、切鋸、打磨、鑽孔以及其他建造操作所導致的粉塵長時間接觸。身穿防護服，用肥皂和水將所接觸到的區域清洗乾淨。**

別讓粉塵進入或接觸到您的嘴巴、眼睛或皮膚！您的身體可能會吸收到有害的化學物質。



小心：操作時請佩戴合適的聽力保護裝置。在某些使用情況下，使用了一定時間後，產品所產生的噪音將有可能讓您的聽力受損。

其他重要的安全警告與說明

延長電線

使用延長電線時，請確保使用電阻足夠小的延長電線來傳送產品需要提取的電流。若電線的電阻不夠小，會引起線路電壓下降，進而導致能量損失與過熱狀況發生。

下表展示了要使用的正確的斷面面積大小，該值取決於電線長度與銘牌上的額定電流值。若有疑問，請使用斷面面積更大一級的電線。斷面面積越小，電線電阻越大。

打磨含鉛漆面

不建議對含鉛漆面進行打磨，因為控制污染粉塵比較困難。鉛中毒對兒童及孕婦的危害最大。

由於在沒有化學分析的情況下難以確定油漆是否含鉛，因此我們建議在對任何漆面進行打磨時採取下列預防措施。

人身安全

- 在完成所有清理工作前，兒童或孕婦不應進入正在執行漆面打磨的工作區域。
- 進入工作區域的所有人應佩戴防塵面罩或口罩。過濾器等應每天或在佩戴者難以呼吸時更換。
註：應僅使用對含鉛油漆塵埃及氣體提供防護的防塵面罩。
普通油漆面罩不提供此防護功能。請諮詢當地的五金經銷商，了解經美國職業安全及衛生研究院 (NIOSH) 批准的合適口罩。
- 不應在工作區域進食、飲水或吸煙，以防吸入油漆污染顆粒。工作人員應在進食、飲水或吸煙前洗手和清理。食品、飲料或煙草不應留下工作區域，塵埃會沉積在它們上面。

環境安全

- 移除油漆時應將產生的塵埃量減到最少。
- 移除油漆的區域應使用 4 公釐厚的塑料片密封。
- 打磨時應儘量減少工作區域外油漆粉塵的痕跡。

功能描述

圖 A

1. 電源開關
2. 底座
3. 排塵口
4. 集塵袋

電機

BLACK+DECKER 工具由 BLACK+DECKER 打造的電機提供動力。請確保您的電源供應器與銘牌上標注的內容一致。110 V AC 僅表示您的工具可使用標準的 60Hz 家用電源。請勿在 DC 上操作 AC 工具。

清潔和處理

- 在執行打磨作業期間，應每天對工作區域中所有表面進行真空清掃和徹底清潔。應經常更換真空過濾袋。
- 滴塑布應該與塵埃或其他碎片收集在一起並處理。應該將它們放入密封的垃圾容器內，並透過常規垃圾收集程序進行處理。清理期間，兒童和孕婦應該遠離工作區域。
- 所有玩具、可清洗之家具及兒童用具應徹底清洗，然後再使用。

請保存這些說明符號

您的工具上可能包含下列符號。符號及其定義如下：

V	伏特	
A	安培	
Hz	赫茲	
W	瓦特	
min	分鐘	
~	或 AC	交流電流
—	或 DC	直流電流
n ₀	空載轉速	
Ⓜ	I 級結構 (接地)	
Ⓧ	接地端子	
⚠	安全警告符號	
Ⓜ	II 級結構 (雙重絕緣)	
.../min 或 rpm...	每分鐘旋轉或鋸切數	
SPM	每分鐘行程	
📖	使用前請閱讀使用手冊	
👁	使用合適的護目鏡	
👂	使用合適的聽力保護裝備	
👤	使用合適的呼吸保護裝置	

製造年份及機號(範例)

2016	23	BM
西元年份	週數	機號

110 V AC/DC 的額定值表示您的工具將使用標準的 60Hz AC 或 DC 電源。此資訊將印於銘牌上。較低的電壓會造成功率損失並導致過熱。所有 BLACK+DECKER 工具已進行出廠檢驗；若此工具無法運作，請檢查電源。

裝配/調節設定



警告：務必在執行下列任何作業前拔下砂磨機的電源插頭。

安裝砂紙 (圖 B)

您的砂磨機專門使用 8 孔集塵模式的 125mm 砂盤。為實現最佳的效果，請使用 BLACK+DECKER 配件。

- 安排砂紙 (5)，請小心地在砂磨機底座 (2) 上將其置中，確保砂紙上的孔與底座上的孔對齊，然後將砂盤緊緊地按壓到位。
- 自黏式底座只需拉動砂紙，即可輕鬆取下，可以依需要重複使用。

操作說明



警告：為了降低嚴重人身傷害的風險，使用本工具前請閱讀、瞭解並遵循所有重要安全警告及說明。

開關

要開啟工具，請如圖 C 所示握住工具，並推按開關 (1) 上標記「I」的部分。要關閉工具，請按開關上標記「O」的部分

操作

抓住砂磨機並將其開啟。將其沿表面以長而廣的行程移動，讓其執行工作。砂磨速度變慢而產生品質不佳的打磨面時，請輕壓工具使用。時常檢查工作情況。

此砂磨機能夠快速清除材料。

集塵 (圖 D)



警告：從砂磨表面塗層 (聚氨酯、亞麻籽油等) 收集的砂磨塵埃可以在砂磨機防塵袋或其他地方發生自燃並引發火災。為降低風險，請頻繁清空防塵袋，並嚴格遵循砂磨機手冊和塗料生產商的說明。

您的砂磨機配備了布料集塵袋 (4) 以收集砂磨時產生的塵埃。

- 要將集塵袋連接到砂磨機，請將集塵袋 (4) 上的凹槽 (6) 與排塵口 (3) 上的結節 (7) 對齊。
- 將集塵袋滑到排塵口上，並順時針轉動集塵袋以將其鎖定位，如圖 D 插頁所示。

- 要取下集塵袋，請逆時針轉動集塵袋並將其滑脫下來。
- 要清空集塵袋，請將其從排塵口取下並砂磨碎片傾倒至適當的垃圾桶中。

維護

請僅使用中性肥皂和濕布清洗工具。不要讓任何液體進入工具；不要讓工具的任何部分浸入液體中。

重要資訊：為了確保產品安全及可靠，維修、維護和調整作業都應該由授權的維修中心或其他合格的維修機構執行，並始終使用相同的替換部件。

電動工具之修理，僅可由認證的技術人員執行。請勿交由非百得認證服務中心的認證技術人員進行修理、維護、調整。若產品經由非百得認證的維修工程師拆解、組裝、調整，恕無法適用百得一年家用保修條款。

請務必使用原廠零件。為充份發揮其功能，修理、維護、調整請務必使用原廠零件。百得認證服務中心擁有保修條款解釋權。

配件



警告：使用任何不建議與本工具配合使用的附件會導致危險。您可透過當地代理商或授權維修中心獲取與本工具配合使用的推薦附件。

維修資訊

無論您需要技術建議、維修或原廠替換零件，請連絡當地經銷商，或最靠近您的 Black & Decker 地點

備註

- BLACK+DECKER 的政策是持續改善我們的產品，因此，我們保留隨時變更產品規格的權利，恕不另行通知。
- 標準設備及配件可能會視國家/地區而有所不同。
- 產品規格可能會根據不同的國家而有所不同。
- 並非在所有的國家/地區都將提供完整的產品系列。

經銷商: 特力股份有限公司
地址: 台北市內湖區新湖三路23號1.2.5樓
電話: 0800-552888

進口/委製廠商: 新加坡商百得電動工具(股)公司台灣分公司
地址: 台北市士林區德行西路33號2樓
電話: 02-2834-1741

設備名稱：偏心砂磨機
Equipment name

型號（型式）：BDERO100
Type designation (Type)

單元 Unit	限用物質及其化學符號 Restricted substances and its chemical symbols					
	鉛Lead (Pb)	汞Mercury (Hg)	鎘Cadmium (Cd)	六價鉻 Hexavalent chromium (Cr ⁺⁶)	多溴聯苯 Polybrominated biphenyls (PBB)	多溴二苯醚 Polybrominated diphenyl ethers (PBDE)
外殼	○	○	○	○	○	○
馬達	○	○	○	○	○	○
電源線	○	○	○	○	○	○
電源開關	○	○	○	○	○	○
內部配線	○	○	○	○	○	○
電路板	○	○	○	○	○	○

備考1. “超出0.1 wt %”及“超出0.01 wt %”係指限用物質之百分比含量超出百分比含量基準值。

Note 1 : “Exceeding 0.1 wt %” and “exceeding 0.01 wt %” indicate that the percentage content of the restricted substance exceeds the reference percentage value of presence condition.

備考2. “○”係指該項限用物質之百分比含量未超出百分比含量基準值。

Note 2 : “○” indicates that the percentage content of the restricted substance does not exceed the percentage of reference value of presence.

備考3. “—”係指該項限用物質為排除項目。

Note 3 : The “—” indicates that the restricted substance corresponds to the exemption.

