

 **BLACK &
DECKER®**

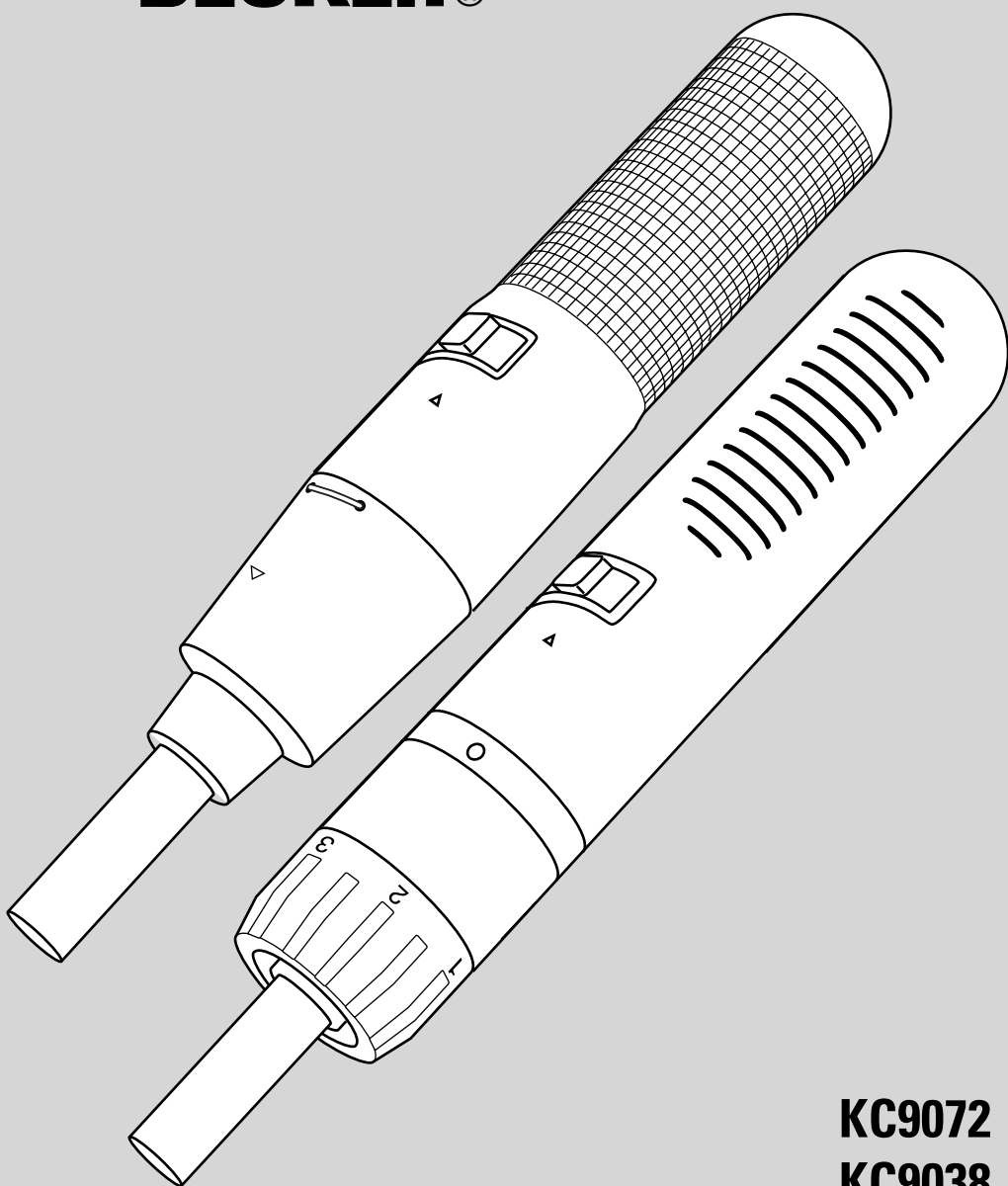

KC9072
KC9038
KC9019

Congratulations!

*On the purchase of your
Black & Decker
cordless screwdriver.*

To ensure the best results from your cordless screwdriver please read these safety and usage instructions carefully. If you have any questions or queries after reading this manual please do not hesitate to call your local service and information centre (the number is towards the back of this manual).

Contents

<i>Page 4</i>	Safety instructions Additional screwdriver and charger safety instructions
<i>Page 5</i>	Double insulation Electrical safety Mains plug replacement Extension Cables Unwanted tools and the environment The Black & Decker guarantee After sales service for your Black & Decker product
<i>Page 6</i>	The after sales service policy Accessories Technical data Features Charging your cordless screwdriver Mounting the charger base
<i>Page 7</i>	Operating your screwdriver Automatic spindle lock Adjustable clutch
<i>Page 8</i>	Pilot holes Handy hints Removing the batteries Rechargeable batteries and the environment EC declaration of conformity Black & Decker phone numbers and addresses Guarantee card

Cordless screwdriver user manual

SAFETY INSTRUCTIONS

Warning! When using electric tools, the following basic safety precautions should always be taken to reduce the risk of fire, electric shock and personal injury. Read all these instructions before attempting to operate this product and save these instructions.

For safe operation:

- We recommend that you take appropriate measures for the protection of hearing if the sound pressure of 85 dB (A) is exceeded.
- **Keep the work area clean.** Cluttered areas and benches invite injuries.
- **Consider work area environment.** Do not expose power tools or chargers to rain. Do not use power tools in damp or wet locations. Keep work area well lit. Do not use power tools in the presence of flammable liquids or gases.
- **Guard against electric shock.** Avoid body contact with earthed or grounded surfaces (e.g. pipes, radiators, ranges, refrigerators).
- **Keep children away.** Do not let visitors touch the tool or extension cord. All visitors should be kept away from work area.
- **Store idle tools.** When not in use, tools and batteries should be stored in a dry, high or locked place, out of reach of children.
- **Do not force the tool.** It will do the job better and more safely at the rate for which it was intended.
- **Use the right tool.** Do not force small tools or attachments to do the job of a heavy duty tool. Do not use tools for purposes not intended; for example, do not use a circular saw to cut tree limbs or logs!
- **Dress properly.** Do not wear loose clothing or jewellery as they can be caught in moving parts. Rubber gloves and non-skid footwear are recommended when working outdoors. Wear protective hair covering to contain long hair.
- **Use safety glasses.** Use a face or dust mask if the cutting operation is dusty or if using in enclosed spaces.
- **Secure your work.** Use clamps or a vice to hold your work. It is safer than using your hand and it frees both hands to operate the tool.
- **Do not overreach.** Keep proper footing and balance at all times.
- **Maintain tools with care.** Keep tools sharp and clean for better and safer performance. Follow instructions for lubricating and changing accessories. Keep handles dry, clean and free from oil and grease.

- **Remove adjusting keys and wrenches.** Form the habit of checking to see that keys and adjusting wrenches are removed from tool before switching it on.
- **Avoid unintentional starting.** Do not carry a tool with a finger on the switch.
- **Stay alert.** Watch what you are doing. Use common sense. Do not operate when you are tired.
- **Check damaged parts.** Before further use of the tool, a guard or other part that is damaged should be carefully checked to determine that it will operate properly and perform its intended function. Check for alignment of moving parts, binding of moving parts, breakage of parts, mounting and any other conditions that may affect its operation. A guard or other part that is damaged should be properly repaired or replaced by an authorised service agent unless otherwise indicated in this instruction manual. Have defective switches replaced by an authorised service agent. Do not use the tool if the switch does not turn it on and off.
- **Warning!** The use of any accessory or attachment, other than recommended in this instruction manual, may present a risk of personal injury.
- **Have your tool repaired by a qualified person.** Repairs should only be carried out by qualified persons using original spare parts, otherwise considerable danger to the user may result.
- This electrical appliance is in accordance with the relevant standards.

Charger plug and cable

- Do not tug at the cable to pull the plug from the socket.
- Make sure the cable is located so that it will not be stepped on, tripped over, or otherwise subjected to damage or stress.
- Keep the cable away from heat, oil, sharp edges and rough surfaces and always ensure it is in good condition.

ADDITIONAL SCREWDRIVER AND CHARGER SAFETY INSTRUCTIONS

- The charger is designed for indoor use only.
- **Do not operate the charger** if it has received a sharp blow, been dropped, or otherwise damaged in any way. Take it to a Black & Decker authorised agent.
- **Never** attempt to connect two chargers together.
- **Always disconnect the supply** before making or breaking connections to the battery.
- Be aware that your screwdriver is always in an operating condition, because it does not have to be plugged into an electrical outlet. When not in use or

when changing accessories, ensure that the selector is in the central position.

- When driving screws into walls, floors etc., check where "live" electrical wires may be encountered. Do not touch any front metal parts of your screwdriver! Hold it only by the plastic housing.
- **Do not** store your screwdriver in locations where the temperature may reach or exceed 50°C/120°F (such as outside sheds or metal buildings in summer).
- **Do not** charge your screwdriver when it or the air temperature is **below** +5°C/40°F or **above** +40°C/105°F.
- **Do not** incinerate your screwdriver, even if it is severely damaged or is completely worn out. The batteries can explode in a fire.
- A small leakage of liquid from the battery cells may occur under extreme usage, charging or temperature conditions. This does not indicate a failure. However, if the seal is broken and this leakage gets onto your skin:
 - Wash quickly with soap and water.
 - Neutralize with a mild acid such as lemon juice or vinegar.
 - If battery liquid gets into your eyes, flush them with clean water for a minimum of 10 minutes and seek medical attention. (Medical note: The liquid is a 25-35% solution of potassium hydroxide).
- **Do not** attempt to open the housing of your charger.
- Your charger and screwdriver are specifically designed to work together.
- Do not attempt to charge any other cordless tool or battery pack with this charger. Do not attempt to charge your screwdriver with any charger other than the one supplied with it.

DOUBLE INSULATION



Your screwdriver is double insulated. This means that all the external metal parts are electrically insulated from the mains power supply. This is done by placing insulation barriers between the electrical and mechanical components making it unnecessary for the tool to be earthed.

Note: Double insulation does not take the place of normal safety precautions when operating the tool. The insulation system is for added protection against injury resulting from a possible electrical insulation failure within your screwdriver.

ELECTRICAL SAFETY

Be sure the supply is the same as the voltage given on the rating plate of your charger. Your charger is fitted with a two-core cable and plug.

MAINS PLUG REPLACEMENT

Should the mains plug or cordset of your charger be damaged, it must only be replaced by an authorised Black & Decker service agent because special purpose tools are required.

EXTENSION CABLES

Up to 30m (100ft) of 3-core extension cable can be used without undue loss of power.

Note: An extension cable should not be used unless absolutely necessary. Use of an improper extension cable could result in a risk of fire and electric shock. If an extension cable must be used, make sure it is properly wired, contains the correct rated fuse as recommended in its literature and is in good electrical condition.

UNWANTED TOOLS AND THE ENVIRONMENT



Should you find one day that the tool needs replacement or is of no further use, think of the protection of the environment. Black & Decker service agents will accept old tools and will dispose of them in an environmentally safe way.

THE BLACK & DECKER GUARANTEE (UK, AUSTRALIA AND NEW ZEALAND ONLY)

If the Black & Decker product becomes defective due to faulty materials and workmanship, within 24 months from the date of purchase, we guarantee to either replace all defective parts or at our discretion, replace the unit free of charge provided that:

- The product is returned to one of our authorised repair agents with evidence of date of purchase.
- The product has not been used for trade, professional or hire purposes.
- The product has not been subjected to misuse or neglect.
- The product has not sustained any damage through foreign objects, substances or accidents.
- Repairs have not been attempted by anyone other than our authorised repair agents.

This guarantee is offered as an extra benefit and is additional to the customers statutory rights.

AFTER SALES SERVICE FOR THE BLACK & DECKER PRODUCT (UK, AUSTRALIA AND NEW ZEALAND ONLY)

Black & Decker offers a nationwide network of authorised service agents. The use of other than genuine Black & Decker accessories and parts may damage or reduce the performance of your Black & Decker product and may also endanger the user. The terms and conditions of the warranty may also be effected.

ENGLISH

THE AFTER SALES SERVICE POLICY (UK, AUSTRALIA AND NEW ZEALAND ONLY)

It is our aim that all Black & Decker customers should be totally satisfied with their Black & Decker product and after sales service, but if help or advice is needed please contact the local Black & Decker service agent who will be happy to help. Full details of our after sales service can be obtained from any of our Black & Decker service agents.

ACCESSORIES

The performance of any power tool is dependant upon the accessory used. Black & Decker accessories are engineered to high quality standards and are designed to enhance the performance of your tool. Buying a Black & Decker accessory will ensure that you get the very best from your Black & Decker tool.

TECHNICAL DATA

The level of sound pressure of the tool is in accordance with EEC legislation. It is recommended that you take appropriate measures for the protection of your hearing if the sound level seems uncomfortable. This normally equates to a sound pressure in excess of 85dB (A).

Note: This user manual also covers more than one catalogue number within this product group. Refer to your carton for details of your product. Your product includes some or all of these features.

FEATURES

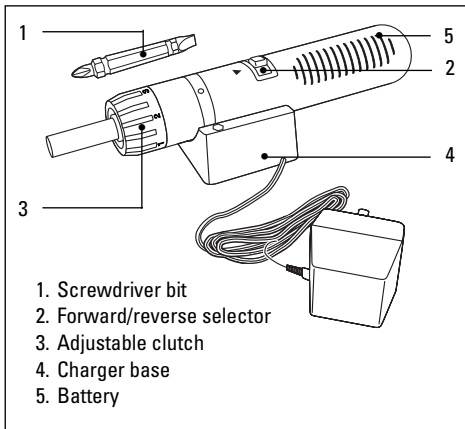

CHARGING YOUR CORDLESS SCREWDRIVER

Important: On delivery, your screwdriver is not charged. Before using your screwdriver for the first

time, charge it for at least 12 hours.

After use place your screwdriver in its base and it will charge automatically. You can leave your screwdriver on charge indefinitely. The charger base is designed to operate 24 hours a day.

While charging, the transformer may hum and become warm to touch. This is a normal condition and does not indicate a problem. When charging, always ensure that the switch is in the central position.

The transformer can remain plugged into the electrical outlet indefinitely with no adverse effects. It will remain slightly warm to the touch if left plugged in; this is normal and does not indicate a problem.

The charger is designed to charge the batteries only and should never be used in an attempt to operate the screwdriver.

If the batteries do not charge properly, check the current at the supply socket by plugging in a lamp or other appliance, and check to see if it can be switched on.

If the supply socket is working and the unit is still not charging, take or send the tool and charger to your local Black & Decker service agent.

Your screwdriver should be recharged when it fails to produce sufficient power on jobs which were easily done previously. Do not continue to use under these conditions. Repeat the charging procedure.

Unplug the charger from the power supply before disconnecting the charger from the tool.

Under certain conditions, with the charger plugged into the power supply, the exposed charging plug can be shorted by foreign material and may cause a fire.

Foreign materials of a conductive nature, such as but not limited to steel wool, aluminium foil, or any build up of metallic particles, should be kept away from the charging plug.

Unplug the charger before attempting to clean.

MOUNTING THE CHARGER BASE

The plastic bag supplied with your screwdriver contains two wood screws and two plastic wall plugs. When you mount the charger base on a wall, use the screws and the wall plugs.

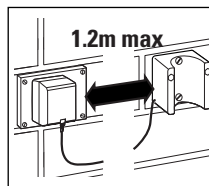

For a wooden surface, use the screws only.

Hold the charger base in the desired position. You must locate this position within 1.2m of the electricity supply.

The charger base is symmetrical and you can mount it either way up.

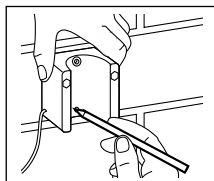

Insert a pencil through one of the two mounting holes to mark its position. Take the charger base away from the wall. Drill a 5.0mm hole in the wall in the desired position.

Insert a plastic wall plug in the hole and gently tap it with a hammer to seat it flush with the wall.

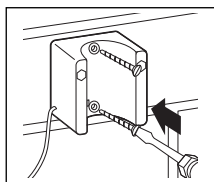

Position the charger base over the wall plug and fit one of the wood screws.

Mark the position of the second hole and remove the charger base. Drill the second mounting hole and

insert the second wall plug. Position the charger base and fit the two mounting screws. When you are mounting the charger base on a wooden surface, drill 2.5mm pilot holes for the wood screws. Do not use the wall plugs.

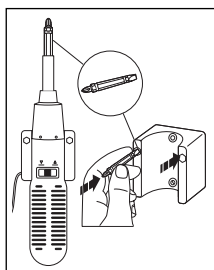

The screwdriver bit supplied with your screwdriver is double-ended with a No. 2 Phillips cross head on one end and a 5mm slotted end on the other. You can store the bit either in the screwdriver or in one of the storage holes in the charger base.

OPERATING YOUR SCREWDRIVER

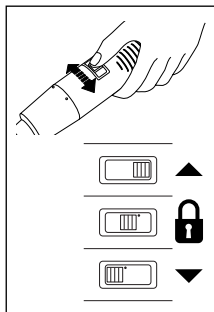

To turn your screwdriver on, in a forward (driving) position, slide the switch to the right to align with the arrow pointing forward.

To operate your screwdriver in reverse (removing screws), slide the switch to the left to align it with the arrow pointing down.

Depress the switch and

your screwdriver will operate. Release the switch and your screwdriver will stop. To turn your screwdriver off, slide the switch to the centre position (no arrows).

AUTOMATIC SPINDLE LOCK

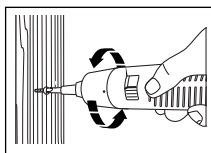

With the switch set to any of its 3 positions, and not depressed, you can use your screwdriver as a conventional non-powered screwdriver. This feature

enables you to give an extra twist to firmly tighten screws or to loosen extra tight screws.

Note: Some of the larger sizes are difficult to seat fully in hardwoods due to variables such as grain irregularity, the moisture content of wood and the amount of charge of your screwdriver. The automatic spindle lock feature will help in these situations.

ADJUSTABLE CLUTCH (TORQUE CONTROL)

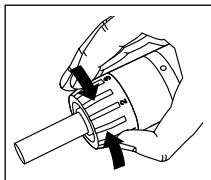

Your screwdriver could have an adjustable clutch feature. This enables you to select the most suitable twisting force for your screwdriving needs.

When the force applied

with your screwdriver reaches the preselected setting, the clutch slips, thereby limiting the tightness of the screw.

Note: The motor of your screwdriver continues to turn as long as the switch is depressed even though the spindle stops rotating as the clutch slips. If the clutch setting is too high for the application, the clutch will not slip; reduce the clutch setting or you will overtighten the screw.

To select the required clutch setting, rotate the adjusting collar clockwise to increase, or anticlockwise to decrease the clutch setting.

There are 23 possible settings, 6 of which are marked on the collar. As the adjusting collar is rotated, a click is heard as the collar locks into the various settings. As a general rule, the longer the screw, the higher the clutch setting needed to drive it, the smaller the screw, the lower the clutch setting required. It is best to start to screw at a low setting and adjust to higher settings until the screw is properly seated.

PILOT HOLES

A pilot hole has two purposes; it acts as a guide for the screw to follow and prevents distortion or splitting of the wood. You should drill pilot holes to a depth equal to or greater than the length of the screw you will use. When working in hardwood, in addition to a pilot hole it is also necessary to drill a clearance hole. The sizes of holes necessary are as follows:

ENGLISH

Screw size	Pilot hole diameter		Clearance hole
	Softwood	Hardwood	Hardwood
No.6 (3.5mm)	2.0mm	2.5mm	4.0mm
No.8 (4.0mm)	3.2mm	3.5mm	5.0mm
No.10 (5.0mm)	3.5mm	4.0mm	5.7mm

HANDY HINTS

- Be careful to avoid over tightening small brass screws. The heads are easily twisted off and the threads can strip. Hand tightening of these screws is recommended.
- Use Posidriv screws whenever possible; they are easier to drive because the screwdriver bit engages more firmly in the screwhead.
- In some cases it is advisable to lubricate the screw thread to make the screwdriving easier. The usual lubricants are soap or washing up liquid smeared on the thread of the screw.
- When drilling in wood using a twist bit, pull the twist bit out of the hole periodically to clear woodchips from the flutes.
- When you insert a wood screw into a hole that is already threaded, start the screw by hand to avoid stripping the threads in the hole. Run the screw in until you feel the threads catch, then use your screwdriver.

RECHARGEABLE BATTERIES AND THE ENVIRONMENT

Black & Decker cordless tools use nickel cadmium (NiCad) batteries or battery packs which can be charged many times to give long life and repeatedly full power.



This symbol indicates the NiCad batteries contained within this unit must be disposed of properly and not discarded in everyday household waste which may be disposed of in an incinerator or landfill site.

NiCad batteries can be harmful to the environment and can explode when exposed to fire. Do not incinerate. Therefore, when your tool or battery pack needs replacing, think of the protection of our environment.

Black & Decker recommends the following:

Discharge batteries completely by running the unit until the energy is completely discharged and then remove from the tool.

REMOVING THE BATTERIES

This should only be done when intending to discard the tool, in order to recycle the batteries.

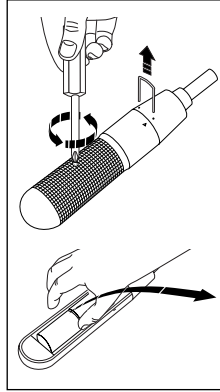

Remove the two pins securing the head of your screwdriver. Remove the casing retaining screw. Strike the casing with a soft-faced hammer to separate the two halves. Remove the batteries from your screwdriver and dispose of them in an environmentally safe way.

EC DECLARATION OF CONFORMITY

We declare that units: **KC9019, KC9038, KC9072** conform to 89/392/EEC, 89/336/EEC, EN55014, 73/23/EEC, EN55104, EN50144
 A weighted sound pressure 70dB (A)
 A weighted sound power 85dB (A)
 Hand/arm weighted vibration 2.5m/s²

Colin Wills - Director of Engineering
 BDC International Ltd, 4F, 2 Dia Wang Street,
 Tai Po Industrial Estate, Tai Po, N.T. Hong Kong

The Black & Decker policy is one of continuous improvement to our product and as such we reserve the right to change the product specification without prior notice.

Australia	Black & Decker (A'asia) Pty Ltd 286-288 Maroondah Highway North Croydon, Victoria 3136	Tel: 03 9213 8200 Fax: 03 9726 7150
New Zealand	Black & Decker 483 Great South Road, Penrose, Auckland	Tel: 09 579 7600 Fax: 09 579 8200
South Africa	Powerdek Tool Distributors 22 Inglestone Road, Village Deep Johannesburg, South Africa	Tel: 011 493 4000 Fax: 011 493 6391
United Kingdom	Black & Decker 210 Bath Road Slough Berkshire SL1 3YD	Tel: 0345 230230 Tel: 01753 511234 Tlx: 848317 BAND MH Fax: 01753 551155

Address of the dealer where your screwdriver was purchased:

Date of your purchase:

Name: _____

House number or name and street: _____

Town: _____

County or state: _____

Postcode: _____

Country: _____

Product catalogue number: KC_____ / _____

Data protection act: Tick this box if you prefer **not** to receive information from Black & Decker or other companies.

Yes

No

Was your screwdriver a gift?

Was your screwdriver your first purchase?

Was your screwdriver bought as a replacement?

What was the price of your screwdriver? _____

Address of the dealer where your screwdriver was purchased:

Product catalogue number: KC_____ / _____

Data protection act: Tick this box if you prefer **not** to receive information from Black & Decker or other companies.

GUARANTEE CARD

Australia: Call 1900 937766 (the maximum call charge is \$2.00 excluding tax)

New Zealand: Call 0900 97766 (the maximum call charge is \$2.00 excluding tax)

South Africa: After sales service, PO Box 5303, Johannesburg 2000

United Kingdom & Ireland: PO Box 821, Slough, Berkshire, SL1 3AR



Please cut out this section, put into a stamped addressed envelope and post immediately after the purchase of your screwdriver to the Black & Decker address in your country (above).

If you live in Australia or New Zealand, please register your purchase by phone.